

Installation

1. Drill an 80mm/3.15" diameter hole into the table.
2. Unscrew the KB2.5*5 screw to detach the cable bushing and the cable pass-through plate from the cable access enclosure.
3. Insert the cable access enclosure into the hole.

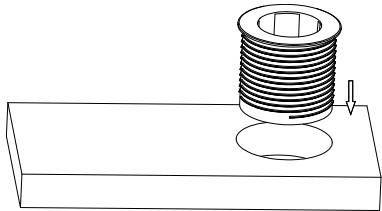

4. Install the mounting bracket under the table using the three Φ3.0*10mm screws included.

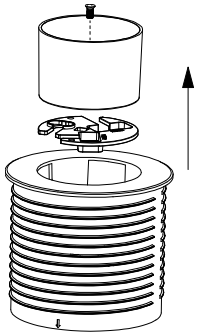
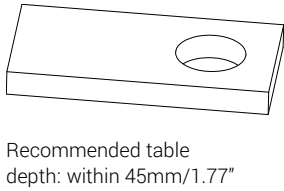
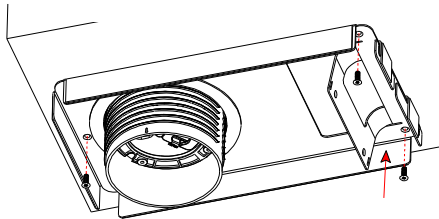

5. Thread the thread sleeve onto the cable access enclosure clockwise from below the table.

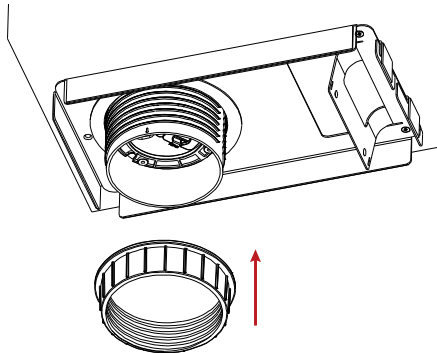

6. Insert one end of the cables through the cable holder's slots and the counterbalance parts respectively as the following shown

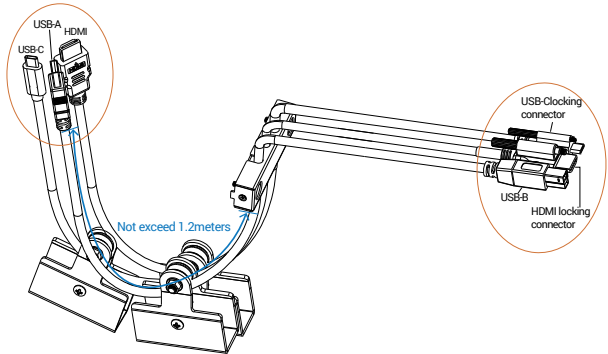

Note: The length of each cable from the end without locking connector to the cable holder shall not exceed 1.2m.

7. Affix the cable holder to the mounting bracket using the M2.5*5mm () and M3*5mm () screws included.

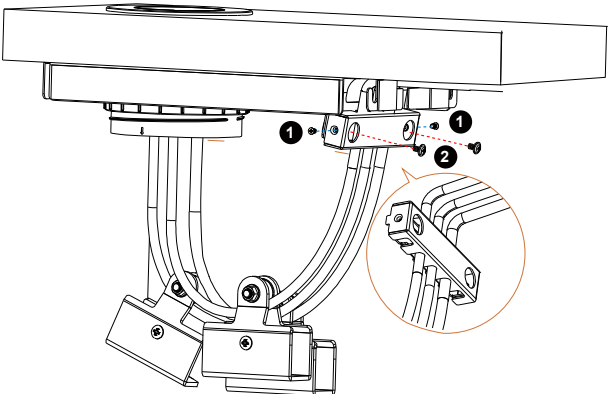

8. Pass the cables upward through the cable access enclosure's corresponding holes, and insert the cable pass-through plate and the cable bushing through the cables in sequence. Then apply the KB2.5*5 screw into the cable access enclosure.

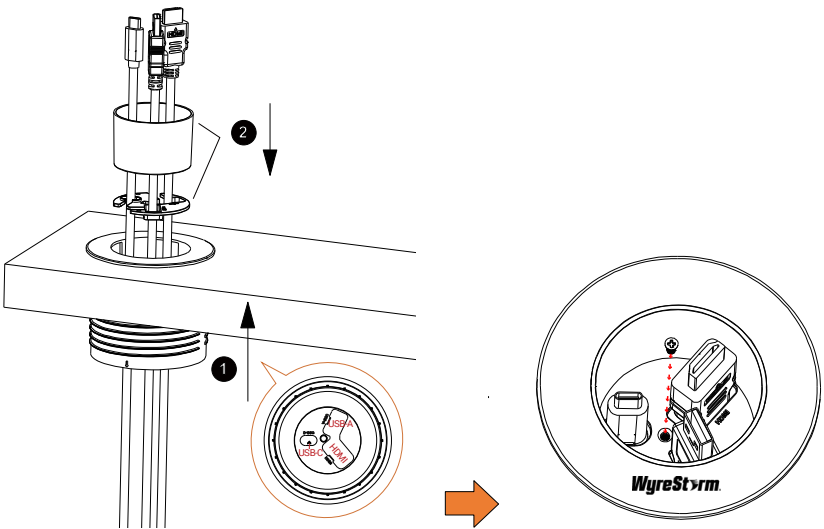

9. Place each cable in an individual compartment of the cable bag included. Affix the cable bag to the four sides of the mounting bracket through the already installed hook and loop strip of the bracket and the bag.

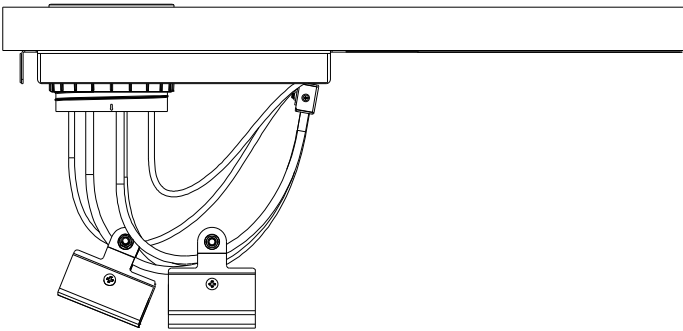

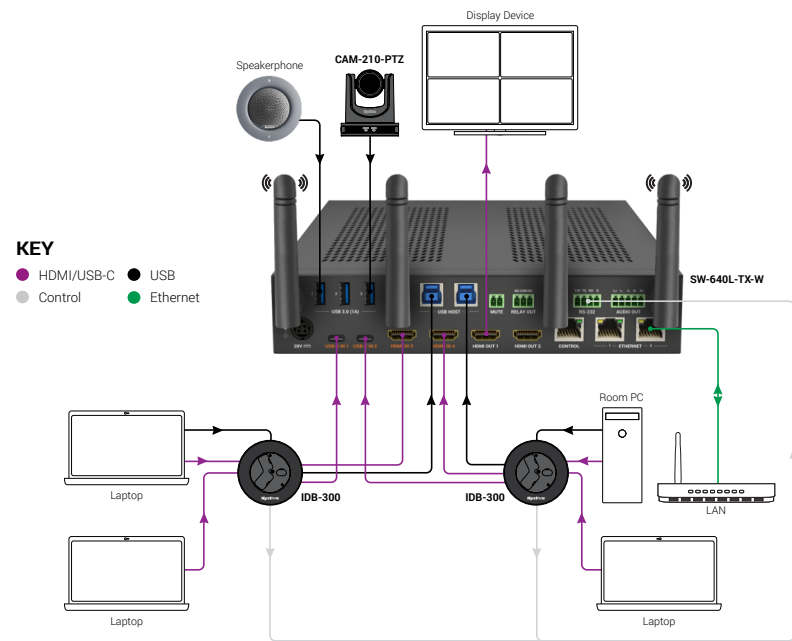

Specifications

Technical	
HDMI Cable	HDMI 2.0 Length: 2m
USB-C Cable	USB 3.1 Gen1 Length: 2m
USB-A to USB-B Cable	USB 3.0 Length: 1.8m
Serial to I/O Cable	Length: 1m
Environmental	
Operating Temperature	0 to + 45°C (32 to + 113 °F), 10% to 90%, non-condensing
Storage Temperature	-20 to +70°C (-4 to + 158 °F), 10% to 90%, non-condensing
Mounting	Flush tabletop mount
Mounting Dimensions and Weight	
Enclosure Dimenstions (W x H)	88mm x 75mm/3.46" x 2.95"
Recommended Table Opening	80mm/3.15"
Min/Max Table Thickness	5mm - 45mm/0.2" - 1.77"
Weight	0.15Kg/0.33lbs (for enclosure only)
Regulatory	
Safety and Emission	CE FCC RoHS RCM EAC UKCA

Warranty Information

WyreStorm Technologies ProAV Corporation warrants that its products to be free from defects in material and workmanship under normal use for a period of five (5) years from the date of purchase. Refer to the Product Warranty page on wyrestorm.com for more details on our limited product warranty.



Retractable In-Desk Box Solution
with USB-C, HDMI & USB 3.0

IDB-300



Quickstart Guide

WyreStorm recommends reading through this document in its entirety to become familiar with the product's features prior to starting the installation process.

IMPORTANT! Installation Requirements

- Read through the [Wiring and Connections](#) section for important wiring guidelines before creating or choosing premade cables.
- Visit the product pages to download the latest firmware, document version, additional documentation, and configuration tools.

Before You Start

The following tools may be required for installation:



Electric Drill



Hole Saw Bit

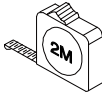

Band Tape

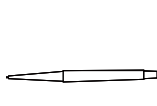

Marker Pen

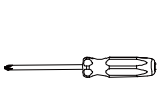

Phillips Screwdriver

Package Contents

WARNING: This product contains small items that could be a choking hazard if swallowed. Before installation, verify that all parts are included and undamaged.

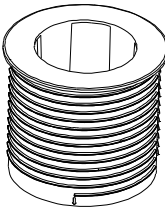

1x Cable Access Enclosure



1x Cable Pass-through Plate



1x Cable Bushing

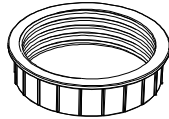

1x Thread Sleeve

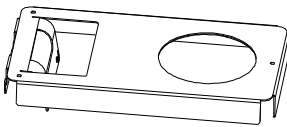

1x Under Table Mounting Bracket



1 x Cable Holder

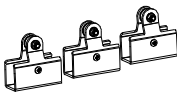

3 x Counterbalance Parts

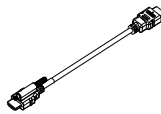

1 x HDMI Cable

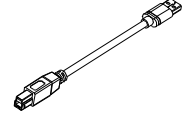

1 x USB 3.0 Type-A to Type-B Cable



1 x USB 3.1 Gen1 Type-C Cable



1 x KB2.5*5 Screw



3 x Φ3.0*10mm Screws



2x M2.5*5 Screws



2x M3*5 Screws

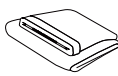

1x Polyester Cable Bag



1x User Guide