

Protocol converter for the SYN-TOUCH10

SYN-CTL-HUB

WyreStorm®

Quickstart Guide

💡 WyreStorm recommends reading through this document in its entirety to become familiar with the product's features prior to starting the installation process.



⚠️ IMPORTANT! Installation Requirements

- Read through the [Wiring and Connections](#) section for important wiring guidelines before creating or choosing premade cables.
- Visit the product pages to download the latest firmware, document version, additional documentation, and configuration tools.

In the Box

- 1x SYN-CTL-HUB
- 2x Mounting Brackets (with Screws)
- 1x IR Emitter
- 1x Quickstart Guide (This Document)

Wiring Diagram

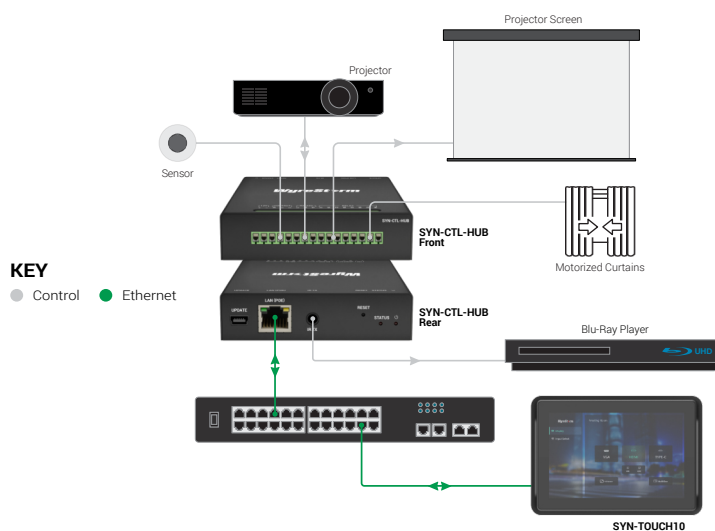

The SYN-CTL-HUB controller can work with the SYN-TOUCH10 touchpad (or any third-party controllers) to control the attached peripherals (e.g. TVs, curtains) through RS-232, IR and/or relay commands.

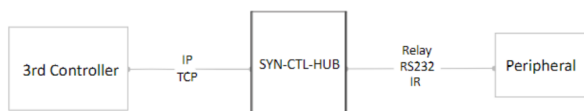

All commands are sent from the touchpad to controller via TCP connection.
The default address of the controller is **169.254.1.51**, and the default port no. is 60005.

General Commands:

Start: BQ

Keepalive:

Send: IQ

Response: LP=0

Wiring and Connections

WyreStorm recommends that all wiring for the installation is run and terminated prior to making connections to the SYN-CTL-HUB. Read through this section in its entirety before running or terminating any wires to ensure proper operation and to avoid damaging the equipment.

IMPORTANT! Wiring Guidelines

- The use of patch panels, wall plates, cable transmitters, kinks in cables, and electrical or environmental interference will have an adverse effect on signal transmission which may limit performance. Steps should be taken to minimize or remove these factors completely during installation for best results.
- WyreStorm recommends using pre-terminated cables due to the complexity of these connector types. Using pre-terminated cables will ensure that these connections are accurate and will not interfere with the performance of the product.

Communication and Connections

RS-232 Wiring

The SYN-CTL-HUB uses a 3-pin RS-232 with no hardware flow control. Most control systems and computers are DTE where pin 2 is RX, this can vary from device to device. Refer to the documentation for the connected device for pin functionality to ensure that the correct connections can be made.

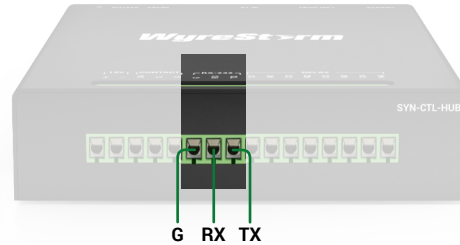

Installation

 **Warning:** Disconnect the device from power source before installation.

The device should be installed on a flat surface, see the following:

1. Position and install the mounting bracket (one for each side) using the mounting screw provided.
2. Repeat above step for the other side of the device.

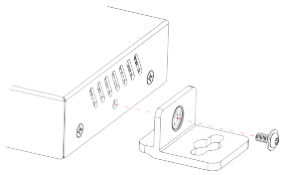

3. Attach the brackets to the desired location.

Troubleshooting

No or Intermittent 3rd party Device Control

Verify that the IR, LAN or RS-232 cables are properly terminated.
Verify the commands being sent are formatted correctly

Warranty Information

WyreStorm Technologies ProAV Corporation warrants that its products to be free from defects in material and workmanship under normal use for a period of five (5) years from the date of purchase. Refer to the Product Warranty page on wyrestorm.com for more details on our limited product warranty.

